

Stand Map
Comp 133A-1-2 South
Parcel # 12125Hb277
 Union County, FL - approx. 369 acres +/-

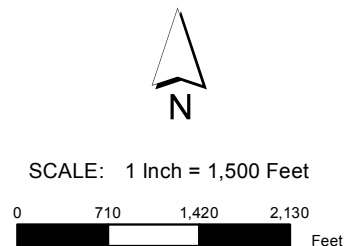
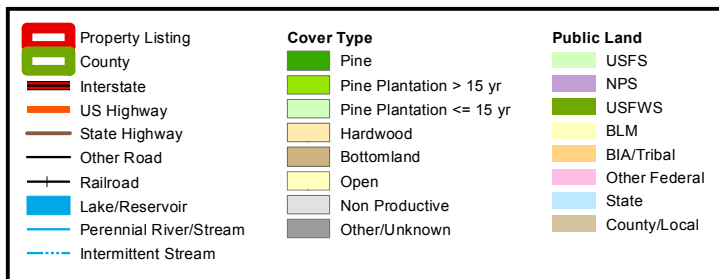

Stand #	Cover Type	Age	Acres
NP	Non Productive	NA	1.4
29	Pine Plantation > 15 yr	17	45.4
30	Pine Plantation <= 15 yr	12	94.0
2038	Hardwood	83	12.9
2042	Hardwood	83	13.3
2043	Hardwood	83	8.3
8242	Hardwood	73	1.2
8332	Pine Plantation > 15 yr	18	55.5
8367	Hardwood	14	68.5
8376	Hardwood	19	1.4
8378	Hardwood	83	50.4
8379	Hardwood	83	16.1

The property depicted on this map has not been surveyed. The acreage is an estimate based upon GIS data. The volume information in this report is based on current information in the seller's inventory system. The information is subject to change due to harvest activities and/or updates resulting from routine maintenance of the inventory system. Neither the owner nor its officers, directors, employees or agents represent or warrant the accuracy or completeness of the ownership acreage, the cover type acreage, timber inventory species, grade or volumes, legal or practical access to the property, or operability.